





A BEAUTIFUL AND STYLISHLY FURNISHED PATIO/GARDEN flat in a CONVERTED GRADE I LISTED BUILDING located on HOVE'S FINEST SEAFRONT SQUARE. The accommodation comprises entrance hall, WEST ASPECT LOUNGE, RECESSED FITTED KITCHEN, BATHROOM, DOUBLE BEDROOM, GAS CENTRAL HEATING, EPC C, A MUST VIEW.

- FLOORPLAN AND VIDEO TOUR
- BEAUTIFUL AND STYLISHLY PRESENTED
- FULLY FURNISHED
- CONVERTED GRADE I LISTED BUILDING
- HOVE'S FINEST SEAFRONT SQUARE
- WEST ASPECT LOUNGE
- RECESSED FITTED KITCHEN
- ONE DOUBLE BEDROOM
- BATHROOM
- PATIO/GARDEN





## LOWER GROUND FLOOR

### ENTRANCE HALL

Ceiling coving, entryphone system, laminated wooden flooring.

### LOUNGE

Two West aspect sash windows with folding wooden shutters, wooden shelving to recess, wooden flooring, two radiators with decorative covers, open to:

### KITCHEN

Modern kitchen fitted with a range of eye level wall cupboards and base cupboard and drawer units, granite worktops and splashbacks, inset stainless steel sink unit with mixer tap, electric oven, electric hob with bespoke extractor fan over, fridge with freezer compartment, washing machine, ceiling coving, spotlights, kick plate lights, tiled floor.

### BATHROOM

Fitted with white suite comprising panelled bath with mixer tap and shower attachment, screen to side, wash hand basin with mixer tap and mirror fronted medicine cabinet over, low level WC, tiled walls, marble tiled floor, chrome ladder style heated towel rail, extractor fan.

### BEDROOM

Ceiling coving, two mirror fronted cupboards, (one housing boiler), further cupboard, wooden flooring, radiator, multi glass pane doors to:

### EXTERNAL

#### PATIO

Astro Turf.

#### COUNCIL TAX BAND C - £2,078.28

#### Full Description

A BEAUTIFUL AND STYLISHLY FURNISHED PATIO/GARDEN flat in a CONVERTED GRADE I LISTED BUILDING located on HOVE'S FINEST SEAFRONT SQUARE. The accommodation comprises entrance hall, WEST ASPECT LOUNGE, RECESSED FITTED KITCHEN, BATHROOM, DOUBLE BEDROOM, GAS CENTRAL HEATING, EPC C, A MUST VIEW.

#### ADDITIONAL

NEW ASSURED SHORTHOLD TENANCIES (ASTs) SIGNED ON OR AFTER 1 JUNE 2019

Holding Deposit (per tenancy)

One week's rent. This is to reserve a property. Please Note: This will be withheld if any relevant person (including any guarantor(s)) withdraw from the tenancy, fail a Right-to-Rent check or provide materially significant false or misleading information. The holding deposit will be offset against the first months rent.

Security Deposit (per tenancy. Rent under £50,000 per year)

Five weeks' rent. This covers damages or defaults on the part of the tenant during the tenancy.

Security Deposit (per tenancy. Rent of £50,000 or over per year)

Six weeks' rent. This covers damages or defaults on the part of the tenant during the tenancy.

Unpaid Rent

Interest at 3% above the Bank of England Base Rate from Rent Due Date until paid in order to pursue non-payment of rent. Please Note: This will not be levied until the rent is more than 14 days in arrears.

Lost Key(s) or other Security Device(s)

Tenants are liable to the actual cost of replacing any lost key(s) or other security device(s). If the loss results in locks needing to be changed, the actual costs of a locksmith, new lock and replacement keys for the tenant, landlord any other persons requiring keys will be charged to the tenant. If extra costs are incurred there will be a charge of £15 per hour (inc. VAT) for the time taken replacing lost key(s) or other security device(s).

LOWER GROUND FLOOR

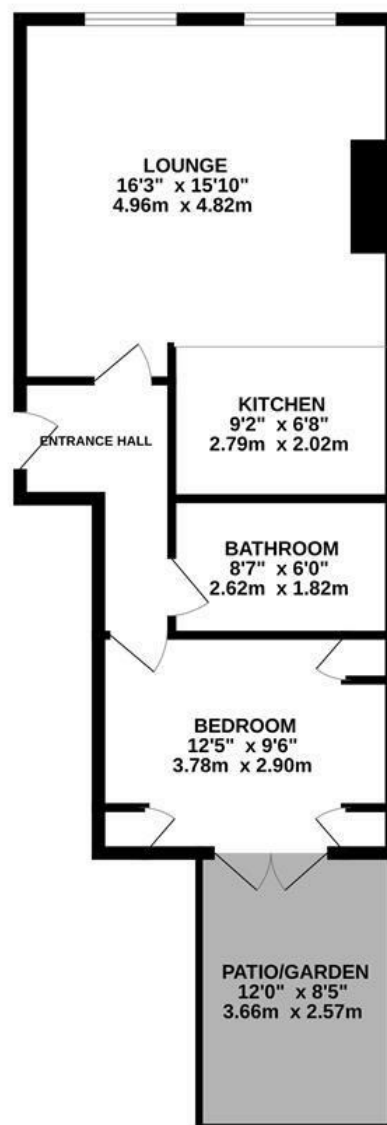





## ENERGY PERFORMANCE CERTIFICATE (EPC)

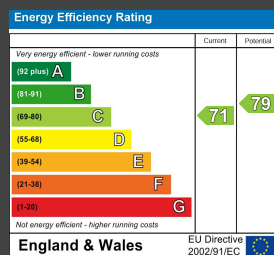

**Council Tax Band: C**

**Maintenance: n/a**

**Lease Length: n/a**

**Ground Rent: n/a**

Tel: 01273 323000

Email: [sales@brices.co.uk](mailto:sales@brices.co.uk)

[www.brices.co.uk](http://www.brices.co.uk)

## DISCLAIMER

Money Laundering Regulations 2007: Intending purchasers will be asked to produce identification documentation upon acceptance of any offer. We would ask for your cooperation in producing such in order that there will not be a delay in agreeing the sale. General: Whilst we endeavour to make our sales particulars fair, accurate and reliable they are only a general guide to the property and accordingly if there is any point which is of particular importance to you please contact the office and we will be pleased to check the position for you. Buyers must check the availability of any property and make an appointment to view, before embarking on any journey to see a property. Items shown in photographs are NOT included unless specifically mentioned within the sales particulars. They may however be available by separate negotiation. Measurements: These approximate room sizes are only intended as general guidance. You must verify the dimensions carefully before ordering carpets or any built in furniture. Services: Please note we have not tested any apparatus, equipment, fixtures and fittings or services and so cannot verify that they are in working order or fit for the purpose. A Buyer is advised to obtain verification from their Solicitor or Surveyor. References to the Tenure of a Property are based on information supplied by the Seller. The Agent has not had sight of the title documents. A Buyer is advised to obtain verification from their Solicitor. These particulars are issued in good faith but do not constitute representations of fact or form part of any offer or contract.

**360°**  
**brices**  
VIRTUAL VIEWINGS

**brices**  
sales & lettings